

Moso® Heizkörperrosette

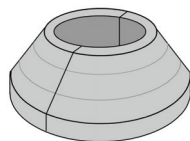

Code Naturhell	Code Gedämpft	Loch Diameter	Oberfläche	Abmessung (mm)
BR100-16	BR150-16	16mm	S	50x50x18
BR100-22	BR150-22	22mm	S	55x55x20

S = Siegel

Moso® Türstopper

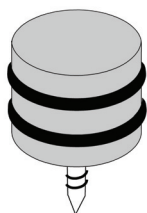

Code Naturhell	Code Gedämpft	Oberfläche	Abmessung (mm)
DS100	DS150	S	32x34 (DiamxHöhe)

S = Siegel

Moso® Treppenkantenprofil



Code Naturhell	Code Gedämpft	Optik	Stärke	Oberfläche	Passend zu:	Abmessung (mm)
BN-PP310	BN-PP360	BL	10mm	-	Bf-la401/bf-la451	2000x50x10/15
BN-SP310	BN-SP360	HL	10mm	-	Bf-la421/bf-la471	2000x50x10/15
BN-PP319	BN-PP369	BL	10mm	S	Bf-la409/bf-la459	2000x50x10/15
BN-SP319	BN-SP369	HL	10mm	S	Bf-la429/bf-la479	2000x50x10/15
BN-DT319	BN-DT369	DT	10mm	SM	Bf-dt409/bf-dt459	2000x50x10/15
BN-PP300	BN-PP350	BL	15mm	-	Bf-la710/la760/la300/la350	2000x55x15/20
BN-SP300	BN-SP350	HL	15mm	-	Bf-la510/bf-la560	2000x55x15/20
BN-PP309	BN-PP359	BL	15mm	S	Bf-la810/la860/la301/la351	2000x55x15/20
BN-SP309	BN-SP359	HL	15mm	S	Bf-la610/bf-la660	2000x55x15/20
BN-SP320	BN-SP370	HL	15mm	S	Bf-la320/bf-la370	2000x55x15/20
BN-SP329	BN-SP379	HL	15mm	S	Bf-la321/bf-la371	2000x55x15/20
BN-DT519	BN-DT569	DT	13mm	SM	Bf-dt301/bf-dt351	1830x55x13/18

BL = Breitlamelle

HL = Hochkantlamelle

DT = Density

S = Versiegelt

SM = Versiegelt matt